

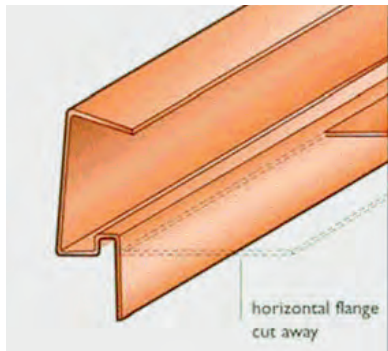

Uni-Line Continuous Dry Verge Fitting Instructions

T Strip and S Strip



1. The top of the gable wall should be reasonably level and free from obstructions. The roofing underlay should be carried across the cavity and the battens fixed in the usual way, ensuring that they finish flush with the other wall or the outer edge of the bargeboard. Select a verge strip of the same or slightly greater length and cut to fit. Make sure that the verge strip is taken to within 25mm (1") of the apex at the ridge. At the eaves you must ensure that the verge strip goes into the gutter by 50mm, a piece should be removed from the horizontal flange in order to carry the line of the sprocket.

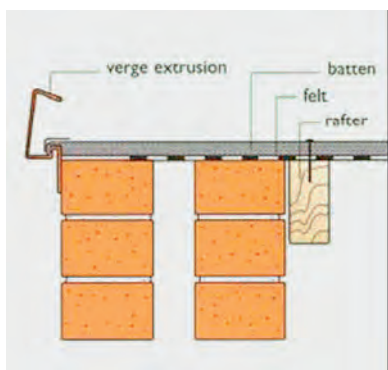

2. The horizontal flange of the verge strip is inserted between the batten and the top of the wall

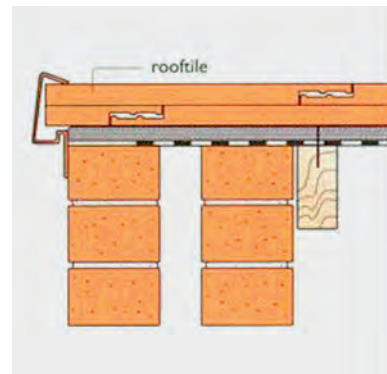

3. As the tiles are laid, ensure that the verge tiles are extended fully into the verge strip where they will be firmly held.

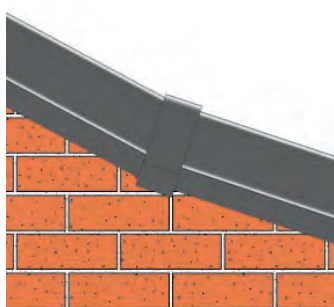

4. T-strip connectors allow for a sprocket eaves and change in pitch up to 15°

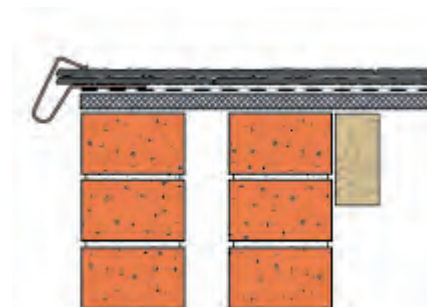

Scot strip

For the Scot Strip follow the instructions above but fix directly onto boarding.