

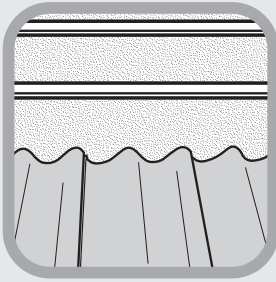

Profile-Line® Vents

Instructions

1



Lay the roof tiles in the normal manner and determine the location of the vent tile, which must be inline with the tile below.

2

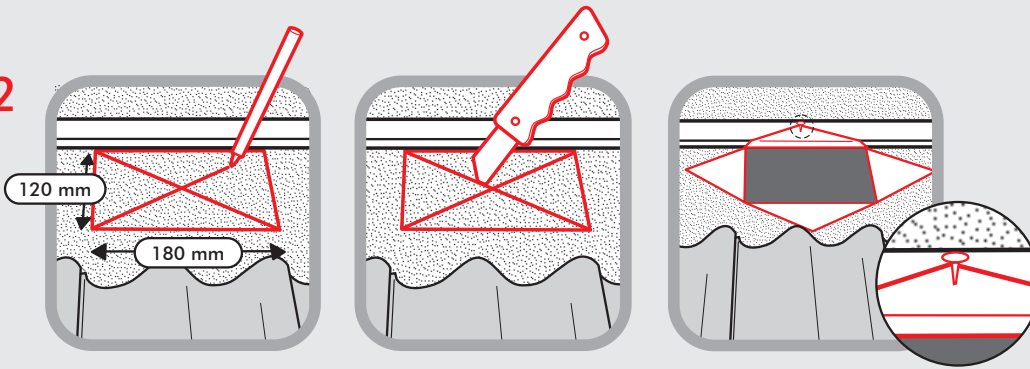

Mark a 120 mm x 180 mm wide rectangle on the underlay directly below the tile batten where the vent is to be fixed. Carry out a star cut within the rectangle and fold the four tabs back and secure the top tab to the tiling batten.

3



Place and fix vent tile in position, ensuring the back spigot passes through the underlay, making sure the fixing lug on the underside of the vent tile is located under the left hand interlock of the roof tile. Then proceed with the tiling in the normal manner. When using the Limarech vent on Redland Renowns or the Single Pantile vent on Centurions, the score lines should be cut/snapped off on the inside edge of the leading face.

Profiles available in the range



When using for ventilation at high level the vent must not be placed directly under the ridge tile.

To meet the requirements of BS5250:2002 for roof ventilation the vents should be installed at the following centres:

- 10,000 mm² low level ventilation – 1 m centres (0.78 m Twin Plain)
- 5,000 mm² high level ventilation – 2 m centres (1.57 m Twin Plain)

For use with mechanical extraction and for soil/vent pipe termination, an adapter (Product Code KG 979100) must be used. A Flexipipe (Product Code KG 979900) is also available.

- Minimum roof Pitch 17.5° (Double Roman, Double Pantile, Limarech) & 20° (Single Pantile, 15x9, Flat Vent) & 22.5° (Twin Plain)
17.5° at 100mm headlap and 22.5° at 75mm headlap (Thin-Line Vent)
- Maximum Headlap 100 mm (95 mm Twin Plain)